

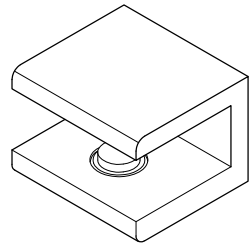

# Glass Shelf Clamp Installation Instructions

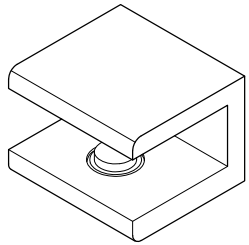

## Parts:

Mounting Screw & Anchor	Set Screw	Clear PVC Film
2 Pcs	2 Pcs	2 Pcs

www.kingstonbrass.com  
 TOLL-FREE CUSTOMER SERVICE: 1-877-2-KBRASS  
 TECHNICAL SUPPORT E-mail: service@kingstonbrass.com  
 12775 Reservoir Street, Chino, CA 91710

**CAUTION**  
 Failure to follow all installation directions may cause product to detach from the wall and cause serious injury

## Tools Required

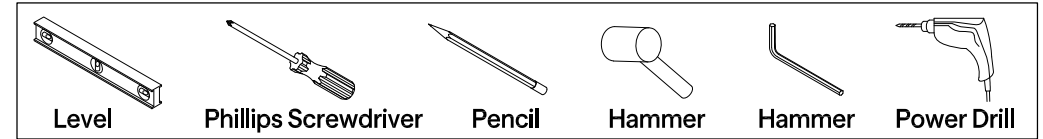

## Installation Instructions :

1. Decide on the desired height for your shelf, then use a level to mark a straight line (Fig 1).
2. Position your brackets 1-1/2" to 2" from each edge, as recommended. Mark their locations (Fig 2).
3. For wall anchors, drill a 3/16" hole and insert the anchor (Fig 3 & 4).
4. If attaching to wood bracing, drill 3/32" pilot holes instead.
5. Fasten the brackets by threading the screws into the drilled holes (Fig 5).
6. Place the glass shelf on the brackets and insert the PVC films between the brackets and the glass. Secure it by tightening the set screw with the included Allen wrench (Fig 6).  
**Caution: Avoid over-tightening, as this may break the glass.**

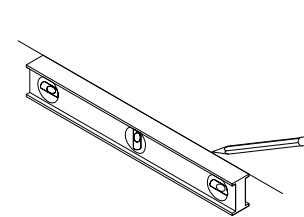

Fig. 1

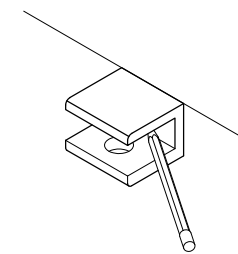

Fig. 2

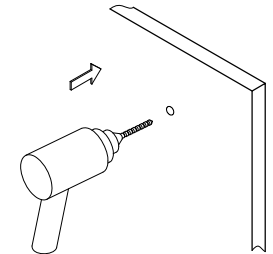

Fig. 3

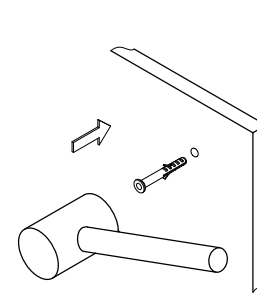

Fig. 4

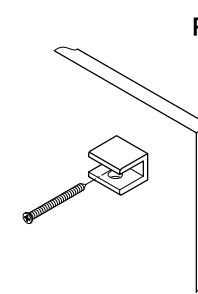

Fig. 5

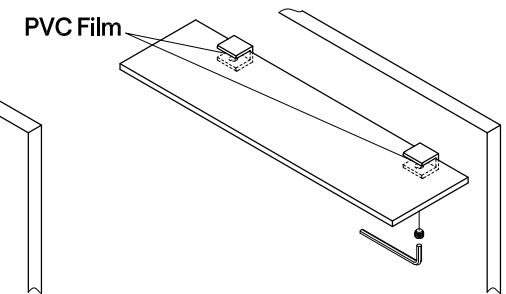

Fig. 6