

KINGSTON

KITCHEN & BATH

INSTALLATION INSTRUCTIONS

Tub Spout

Assembly Instruction:

Remove Old Spout by turning in a clockwise direction.

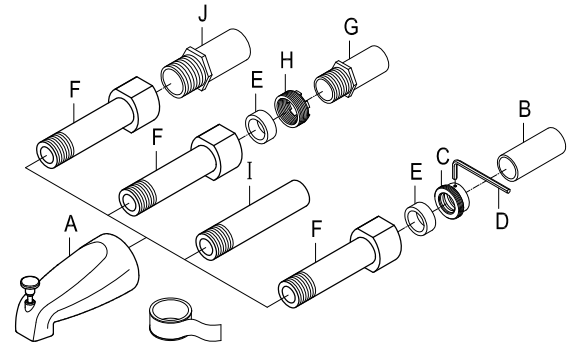

FOR 1/2" COPPER PIPE CONNECTION :

Tools Required: Hex Wrench (Included)

1. The length of copper pipe (B) from the finished wall should be at least 1" to maximum 2".
2. Trim the end of copper pipe. Chamfer the pipe end (B) and remove all burrs to avoid damaging the O-ring.
3. Loosen the screw set. Slip the adapter (C) on copper pipe (B) until it's in contact with the finished wall. Tighten with hex wrench (D) .
Caution: DO NOT OVERTIGHTEN as it may damage the copper pipe.
4. Slip the rubber gasket (E) until it is in contact with the adapter (C) .
5. Wrap the threads of adapter (C) with Teflon tape. Assemble the extension nipple (F) to the copper pipe until the adapter (C) is completely covered under the extension nipple (F) .
6. Wrap the male threads of the extension nipple (F) with Teflon tape. Thread the spout (A) to the extension nipple (F) by manually turning in a clockwise direction.

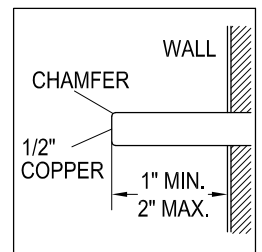

FOR 1/2" MALE PIPE CONNECTION WITH THREADED END:

1. Wrap the threads of the wall nipple (I) with Teflon tape.
2. Thread the spout (A) to the wall nipple (I) by manually turning in a clockwise direction.

FOR 1/2" MALE THREADED CONNECTION:

1. Wrap the male threads of the wall nipple (G) with Teflon tape.
2. Assemble the reducer adapter (H) to the wall nipple (G), and wrap the threads of reducer adapter (H) with Teflon tape.
3. Insert the rubber gasket (E) into extension nipple (F) .
4. Assemble the extension nipple (F) to the reducer adapter (H) until the adapter is completely covered.
5. Wrap the male threads of the extension nipple (F) with Teflon tape. Thread the spout (A) to the extension nipple (F) by manually turning in a clockwise direction.

FOR 3/4" MALE THREADED CONNECTION:

1. Wrap the male threads of the wall nipple (J) with Teflon tape.
2. Assemble the extension nipple (F) to the 3/4" wall nipple (J) until the nipple is completely covered.
3. Wrap the male threads of the extension nipple (F) with Teflon tape.
4. Thread the spout (A) to the extension nipple (F) by manually turning in a clockwise direction.

Note: To ensure the Teflon tape perform properly disregarding the tape thickness, it is recommended to wrap 3 revolutions or more cycles.

NOTICE

Failure to follow all directions may cause leaks which may result in water damage

CAUTION

Failure to follow all installation directions may cause product to detach from the wall and cause serious injury

www.kingstonbrass.com
TOLL-FREE CUSTOMER SERVICE: 1-877-2-KBRASS
TECHNICAL SUPPORT E-mail: service@kingstonbrass.com
12775 Reservoir Street, Chino, CA 91710

© 2023-07-T Kingston Brass