

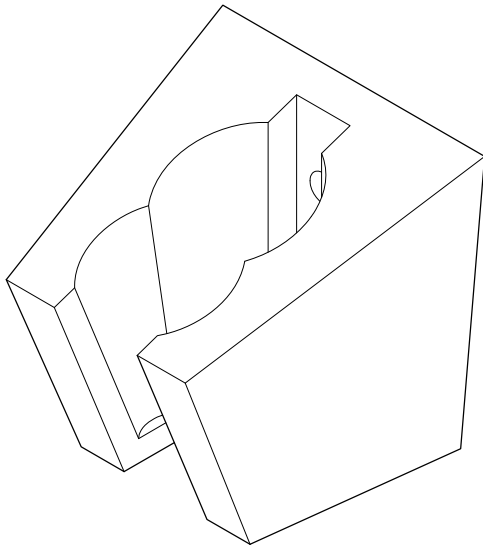

Wall Bracket Installation Instructions



Parts:

Mounting
Screw &
Anchor

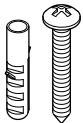

2 Pcs

www.kingstonbrass.com

TOLL-FREE CUSTOMER SERVICE: 1-877-2-KBRASS
TECHNICAL SUPPORT E-mail: service@kingstonbrass.com
12775 Reservoir Street, Chino, CA 91710

CAUTION

Failure to follow all installation directions may
cause product to detach from the wall and
cause serious injury

Tools Required

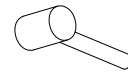

Hammer



Marking Pencil

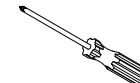

Phillips Screwdriver

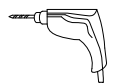

Power Drill

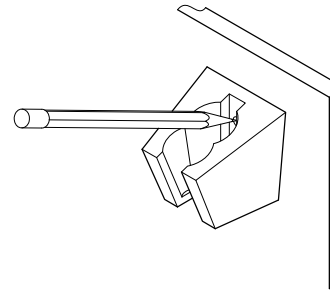

Fig. 1

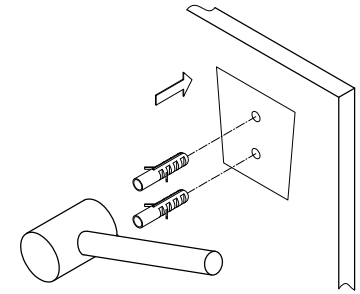

Fig. 2

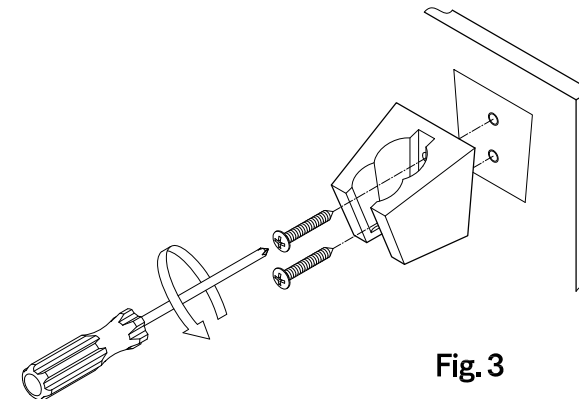

Fig. 3

Installation Steps:

- Step 1. Locate position on the wall and mark outline of cover plate on the wall (fig. 1).
- Step 2. Locate wall bracket in the center of outline. Mark location of the mounting screw (fig.1) and drill holes at the marked location.
- Step 3. Insert anchors into the holes until flush with wall (fig. 2).
- Step 4. Screw the wall bracket to wall with mounting screw (fig. 3).

Cleaning

Clean with a damp cloth only.
Avoid using metal or abrasive polishes.