

# KINGSTON

KITCHEN & BATH

## INSTALLATION INSTRUCTIONS

### Switch Button

#### Instructions:

1. Insert rubber washer on air switch threads, insert air switch through a 1-3/8" hole on the counter top.
2. From below, insert plastic washer and thread plastic nut until the air switch is properly fastened.
3. Attach power module to the wall using the attached screws (2 flat screws on top, 1 pan head screw on the bottom)
4. Insert small plastic nut on both ends of the air hose, push one end on the air inlet of the power module and the other end on the air outlet of the air switch, hand tighten both nuts to secure the air hose.
5. Plug module into grounded outlet and plug garbage disposal into the B socket of the power module.

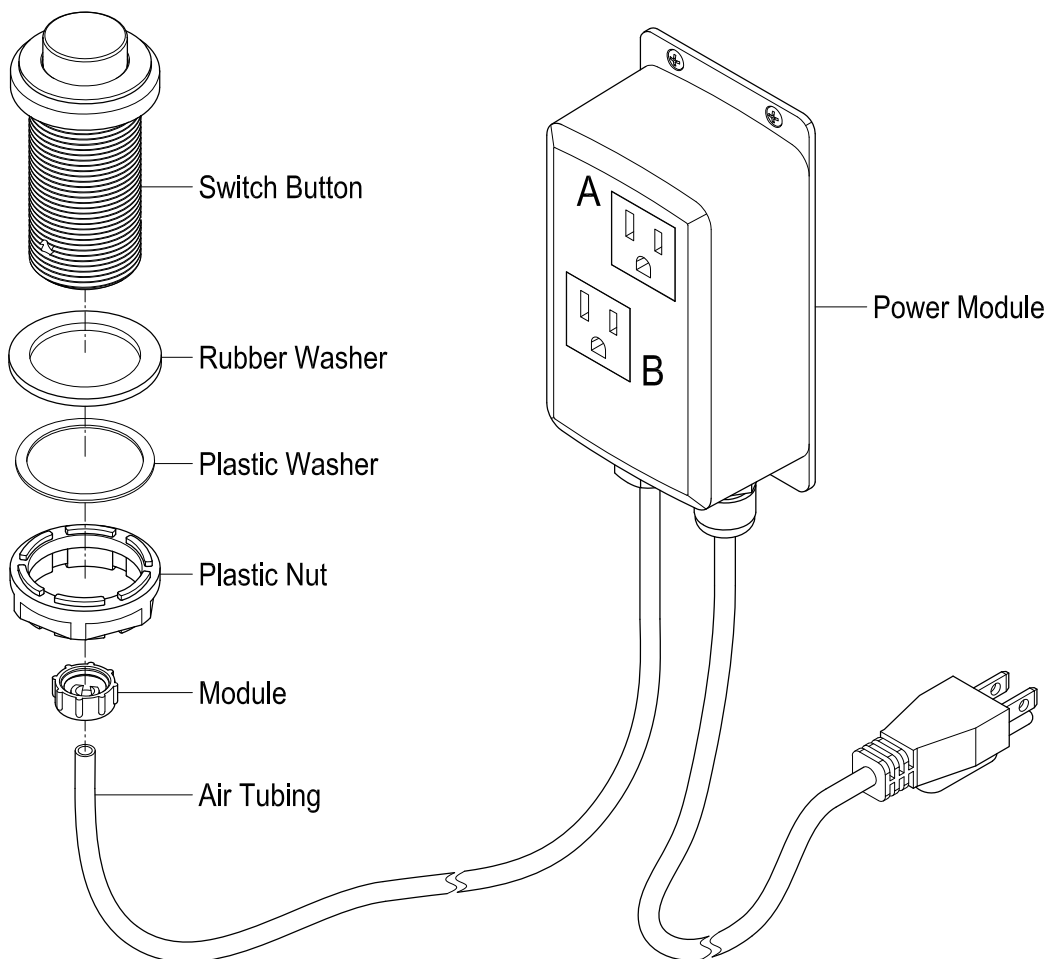

**⚠ DANGER**

Hazardous voltage (120v).  
Contact may cause electrical shock and injury.  
Disconnect power before servicing  
This equipment is to be serviced by trained  
personnel only

[www.kingstonbrass.com](http://www.kingstonbrass.com)  
TOLL-FREE CUSTOMER SERVICE: 1-877-2-KBRASS  
TECHNICAL SUPPORT E-mail: [service@kingstonbrass.com](mailto:service@kingstonbrass.com)  
12775 Reservoir Street, Chino, CA 91710