

KINGSTON

KITCHEN & BATH

INSTALLATION INSTRUCTIONS

Switch Button

Instructions:

1. Insert rubber washer on air switch threads, insert air switch through a 1-3/8" hole on the counter top.
2. Tighten the plastic nut under the sink counter to ensure well installation.
3. Attach power module to the wall using the attached screws (2 flat screws on top, 1 pan head screw on the bottom)
4. Insert small plastic nut on both ends of the air hose, push one end on the air inlet of the power module and the other end on the air outlet of the air switch, hand tighten both nuts to secure the air hose.
5. Plug module into grounded outlet and plug garbage disposal into the B socket of the power module.

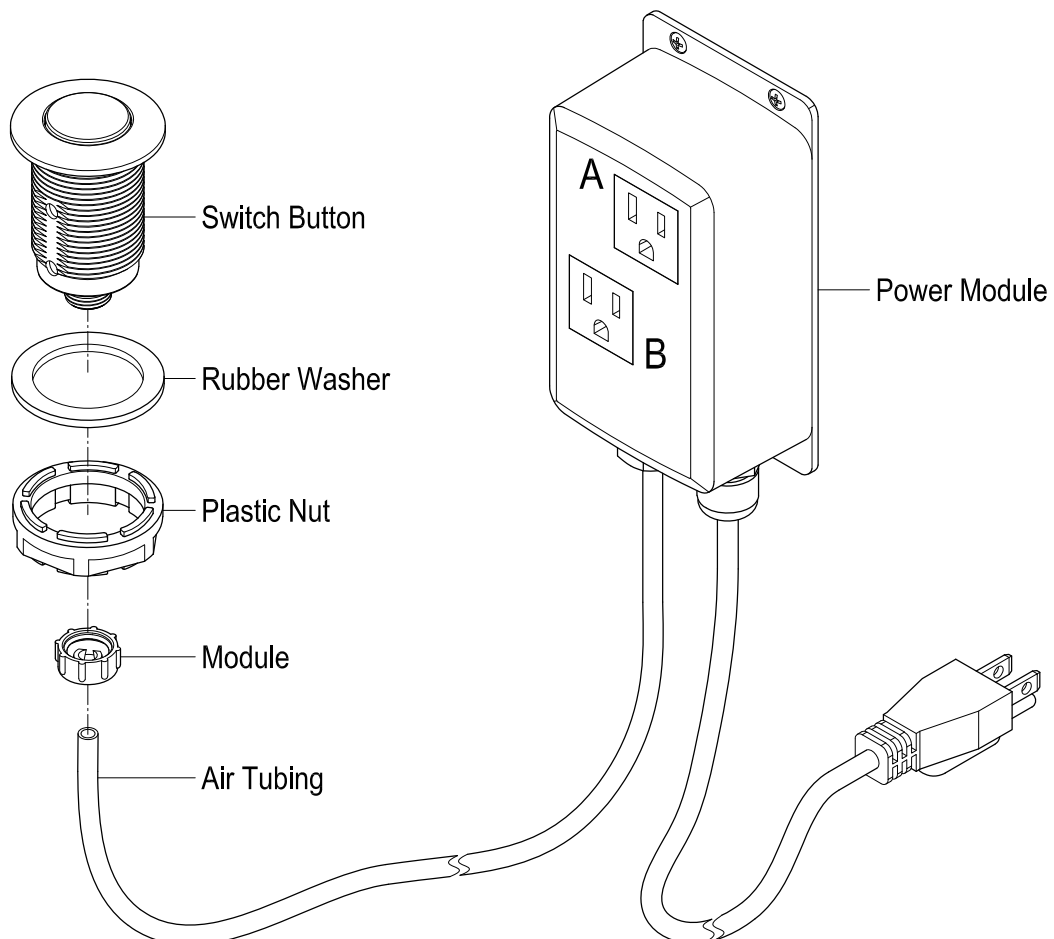

⚠ DANGER

Hazardous voltage (120v).
Contact may cause electrical shock and injury.
Disconnect power before servicing
This equipment is to be serviced by trained
personnel only

www.kingstonbrass.com
TOLL-FREE CUSTOMER SERVICE: 1-877-2-KBRASS
TECHNICAL SUPPORT E-mail: service@kingstonbrass.com
12775 Reservoir Street, Chino, CA 91710