





## Repair Instruction Manual for KSRP2331D Diverter

<p>Tools</p>	<p>Needle nose pliers</p> 	<p>10mm Hex allen wrench</p> 	<p>Adjustable Wrench</p> 
<p>Repair part</p>	<p>Diverter parts(# KSRP2331D)</p> 		
<p>Step</p>	<p>Photo</p>		<p>Description</p>
<p>1.</p>			<p>Use wrench to loosen the adapter beneath the spout by turning counter-clockwise and then carefully pull out the spout from the faucet body.</p>
<p>2.</p>			<p>Use a 10mm Hex Allen wrench to loosen the diverter inside the faucet body by turning counter-clockwise.</p>

3.

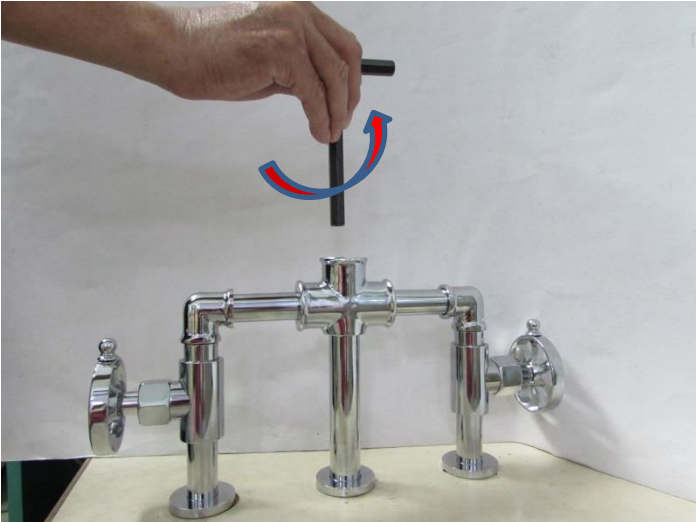
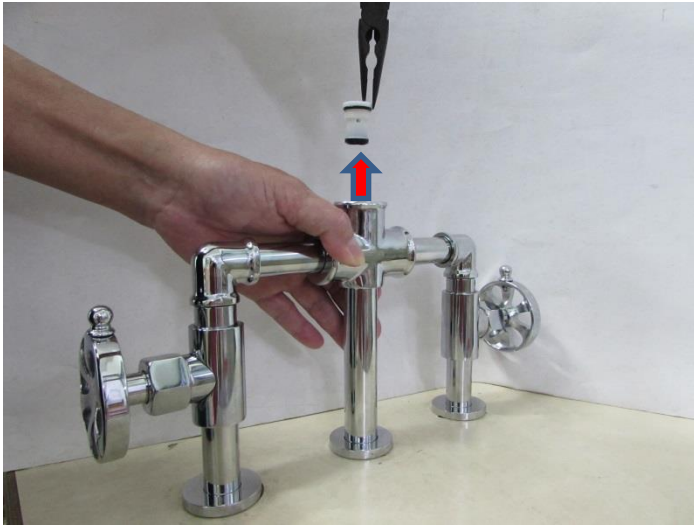

Use a needle nose plier to remove the diverter from the faucet body and clean all impurity or debris inside the body.

4.

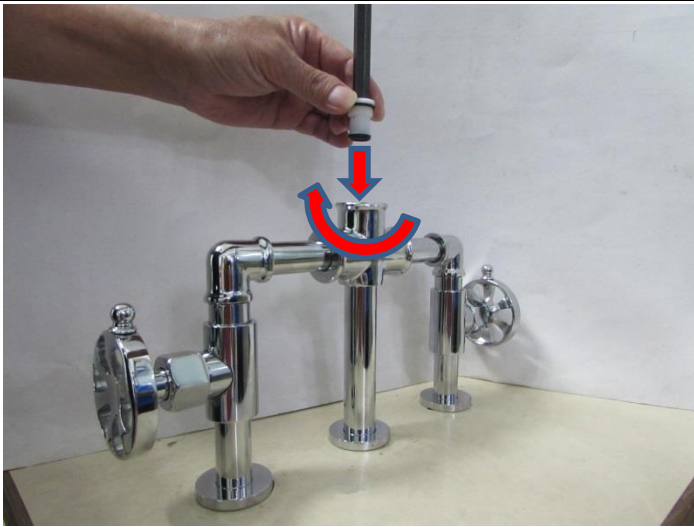

Install a new diverter onto the faucet body by turning clockwise the Allen wrench about 4 or 5 rounds.

5.



Install the spout onto faucet body with wrench by tighten up the adapter in clockwise.